



# INTEGRATED PIPELINE PROJECT

## MONTHLY EXECUTIVE SUMMARY

March 2019



*JCC1 Aerial view of JCC1 Intake, Pump Station and Electrical Substation*

### IPL PROGRAM MANAGEMENT

Tarrant Regional Water District

804 East Northside Drive

Fort Worth, TX 76102

817.720.4469 p

817.720.4397 f

[iplproject.com](http://iplproject.com)

[@IPL\\_Project](https://twitter.com/IPL_Project)

### TARRANT REGIONAL WATER DISTRICT (TRWD) and the CITY OF DALLAS

**WATER UTILITIES (DWU)** have partnered to finance, plan, design, construct and operate the Integrated Pipeline (IPL) Project. The IPL Project is an integrated water delivery transmission system connecting Lake Palestine to Lake Benbrook with connections to Cedar Creek and Richland-Chambers Reservoirs integrating TRWD's existing pipelines and creating flexibility in delivery as well as quick response to fluctuating customer water demands. The IPL Project consists of 150 miles of pipeline, three new lake pump stations, and three new booster pump stations delivering a required capacity of 350 million gallons per day (MGD) of raw water to North Central Texas. TRWD and DWU currently serve over 4.1 million residents and the IPL will allow these agencies to continue supporting regional community and economic growth.

# PROGRAM SUPPORT SERVICES

as of 03.31.19

CONTRACT DESIGN AND CONSTRUCTION	DESCRIPTION	BUDGET	CONTRACTS ISSUED	TOTAL INVOICED
<b>PROGRAM WIDE PROFESSIONAL SERVICES</b>		<b>\$133,062,000</b>	<b>\$88,687,926</b>	<b>\$85,029,912</b>
<b>Program Management</b>	Overall program management services for implementation of the IPL Project. (Extension of TRWD staff)	\$45,000,000	\$35,124,711	\$35,124,711
<b>Conceptual Design / Environmental / Permitting</b>	Operations plan & Prepare 404 permit application, Envision Application Completion	\$13,551,000	\$13,194,525	\$13,248,699
<b>Value Engineering</b>	Expert review of design	\$640,000	\$472,248	\$472,248
<b>Surveying and Mapping</b>	Control, property survey, legal descriptions, and Provide SUE Level A Survey, GIS	\$14,600,000	\$11,854,388	\$10,593,852
<b>Geotechnical</b>	Initial Characterization of entire IPL Project	\$12,037,000	\$12,336,425	\$12,195,421
<b>Corrosion Engineering Services</b>	Engineering Corrosion Control	\$3,891,000	\$5,326,362	\$4,286,893
<b>Land, Easement Acquisition, &amp; Support Studies</b>	Right of Entry and Land Acquisition Support Services	\$33,993,000	\$3,464,526	\$3,429,501
<b>SCADA System</b>	Engineering of SCADA system	\$640,000	\$1,508,213	\$622,393
<b>Microwave System</b>	Engineering of Communications System	\$5,210,000	\$1,522,785	\$1,468,609
<b>DESIGN</b>		<b>\$152,837,000</b>	<b>\$133,869,306</b>	<b>\$121,276,618</b>
<b>Completed</b>		<b>\$101,901,000</b>	<b>\$97,470,103</b>	<b>\$97,160,762</b>
<b>Active</b>		<b>\$24,158,000</b>	<b>\$35,860,787</b>	<b>\$24,115,856</b>
<b>CH2M Hill</b>	Project Operational Information and Operations Manual		\$6,479,844	\$4,049,980
<b>CH2M Hill</b>	Final Conformance of Design of JCC1	\$728,000	\$3,377,790	\$3,123,474
<b>MWH</b>	Final Conformance of Design of Section 9/10/11	\$506,000	\$812,562	\$555,735
<b>Black &amp; Veatch</b>	Final Design of Section 12/13/14 - 28.1 miles of 84 - inch and 108 - inch pipeline	\$11,292,000	\$9,712,410	\$9,700,648
<b>Parsons</b>	Final Conformance of Design of Sections 17/18/Tunnel	\$832,000	\$579,379	\$681,545
<b>Brown &amp; Gay</b>	Final Design of Section 19-1	\$5,770,000	\$7,003,722	\$1,957,619
<b>HDR</b>	Final Design of Section 19-2	\$5,030,000	\$6,989,876	\$3,180,212
<b>Burns &amp; McDonnell Trans. Mgmt.</b>	Development of Transportation Management Plan		\$905,203	\$866,643
<b>Remaining</b>		<b>\$26,778,000</b>	<b>\$538,417</b>	
<b>CONSTRUCTION ADMINISTRATION</b>		<b>\$48,877,000</b>	<b>\$18,550,960</b>	<b>\$13,078,975</b>
<b>CONSTRUCTION / OWNER FURNISHED EQUIPMENT</b>		<b>\$1,729,540,000</b>	<b>\$713,675,145</b>	<b>\$612,140,900</b>
<b>Completed</b>		<b>\$26,677,000</b>	<b>\$20,634,788</b>	<b>\$20,418,083</b>
<b>Active</b>		<b>\$875,818,000</b>	<b>\$693,040,357</b>	<b>\$591,722,817</b>
<b>Pipeline Section 15-1</b>		<b>\$115,112,000</b>	<b>\$93,687,256</b>	<b>\$93,687,256</b>
<b>Garney Construction</b>	Construction of Section 15-1	\$115,112,000	\$93,687,256	\$93,687,256
<b>JB3</b>		<b>\$83,013,000</b>	<b>\$75,677,126</b>	<b>\$70,276,899</b>
<b>MWH Constructors</b>	Construction of JB3 Pump Station	\$51,473,000	\$57,935,973	\$55,859,676
<b>Oncor Electric</b>	Installation of JB3 Substation Transmission Lines	\$1,066,000	\$957,119	\$923,119
<b>Isolux Corsan</b>	Construction of JB3 Substation	\$7,400,000	\$4,864,888	\$4,864,888
<b>R E Monks</b>	Construction of JB3R Restoration	\$0	\$633,263	\$633,263
<b>Pentair Flow Technologies</b>	Construction of JB3 Pumps, Motors, Drives	\$23,074,000	\$11,285,883	\$7,995,953
<b>Pipeline Section 12/13/MBR/IB4 Bypass</b>		<b>\$167,992,000</b>	<b>\$153,924,053</b>	<b>\$153,468,983</b>
<b>Thalle Midlothian</b>	Construction of Sections 12/13/MBR/IB4 Bypass	\$146,310,000	\$143,614,761	\$143,167,207
<b>BAR Constructors</b>	Construction of Richland-Chambers/Cedar Creek Interconnection Facility	\$21,682,000	\$10,185,063	\$10,177,546
<b>Hilco Electric</b>	Relocation of Electrical Service Lines		\$0	\$0
<b>Hilco Electric</b>	MBR Radio Tower Power		\$33,312	\$33,312
<b>Oncor Electric</b>	Provide Power to IPL 2X12		\$90,918	\$90,918

# PROGRAM SUPPORT SERVICES

as of 03.31.19

CONTRACT DESIGN AND CONSTRUCTION	DESCRIPTION	BUDGET	CONTRACTS ISSUED	TOTAL INVOICED
<b>Pipeline Section 15-2</b>		<b>\$97,217,000</b>	<b>\$50,743,593</b>	<b>\$50,743,593</b>
<b>BAR Constructors</b>	Construction of Section 15-2	\$97,217,000	\$50,743,593	\$50,743,593
<b>Pipeline Section 14</b>		<b>\$107,113,000</b>	<b>\$47,130,639</b>	<b>\$47,130,639</b>
<b>Garney Construction</b>	Construction of Section 14	\$107,113,000	\$47,080,639	\$47,080,639
<b>Magellan</b>	Captioned Crossing Inspection Section 14	\$0	\$50,000	\$50,000
<b>Pipeline Section 17</b>		<b>\$109,944,000</b>	<b>\$94,280,216</b>	<b>\$66,003,319</b>
<b>IPL Partners</b>	Construction of Section 17 Tunnel	\$12,252,000	\$48,500,000	\$24,619,196
<b>Thalle Midlothian</b>	Construction of Sections 17/18/IB2 Bypass	\$97,692,000	\$45,780,216	\$41,384,123
<b>JCC1</b>		<b>\$106,582,000</b>	<b>\$105,572,358</b>	<b>\$42,121,493</b>
<b>BAR Constructors</b>	Construction of JCC1 Intake	\$21,564,000	\$18,960,214	\$18,903,323
<b>BAR Constructors</b>	Intake Facility & OFE Installation Package 2	\$63,900,000	\$63,336,179	\$9,377,718
<b>Ebara</b>	Construction of JCC1 Pumps, Motors, Drives	\$17,775,000	\$12,694,890	\$3,832,089
<b>Lambda Construction</b>	High Voltage		\$5,824,825	\$5,252,112
<b>Oncor Electric</b>	Construction of JCC1 HV Transmission Lines	\$3,343,000	\$4,756,250	\$4,756,250
<b>Pipeline Section 10/11</b>		<b>\$73,679,000</b>	<b>\$57,718,822</b>	<b>\$55,127,306</b>
<b>IPL Partners</b>	Construction of Section 10/11	\$72,362,000	\$43,815,594	\$41,555,700
<b>Oncor Electric</b>	Construction of KBR S1X10 HV Transmission Lines		\$17,452	\$17,452
<b>BAR Constructors</b>	Construction of KBR S1X10	\$1,317,000	\$13,885,776	\$13,554,154
<b>Valve Packages</b>		<b>\$15,166,000</b>	<b>\$14,306,294</b>	<b>\$13,163,328</b>
<b>Garney Construction</b>	Valve Package 1 - Section 15-1 Butterfly Valves	\$518,000	\$0	\$0
<b>Rodney Hunt</b>	Valve Package 2 - Section 15-1 Interconnection Facility Valves	\$474,000	\$733,206	\$733,206
<b>Blackhall Engineering</b>	Valve Package 3 - JB3, Section 15-2, MBR Yard Gate Valves	\$5,500,000	\$6,278,388	\$6,211,694
<b>Crispin Valves</b>	Valve Package 4 - Section 12 RC/CC Interconnection, JB4 Bypass, MBR Yard Butterfly Valves	\$3,999,000	\$2,269,140	\$2,187,448
<b>Crispin Valves</b>	Valve Package 5 - JB3 Butterfly Valves	\$1,249,000	\$1,249,222	\$1,039,098
<b>Ross Valves</b>	Valve Package 6 - Section 12 RC/CC Interconnection Multi-Orifice Valves	\$715,000	\$526,340	\$478,838
<b>Crispin Valves</b>	Valve Package 8 - Section 10 & 11 Bypass Butterfly Valves	\$1,391,000	\$1,461,040	\$1,325,916
<b>Blackhall Engineering</b>	Valve Package 11 - JCC1 Gate Valve	\$1,320,000	\$1,788,958	\$1,187,128
<b>Remaining</b>		<b>\$827,045,000</b>		
<b>CONSTRUCTION MANAGEMENT</b>		<b>\$65,170,000</b>	<b>\$51,849,779</b>	<b>\$40,834,246</b>
<b>Completed</b>		<b>\$15,777,000</b>	<b>\$15,687,599</b>	<b>\$18,004,219</b>
<b>Active</b>		<b>\$17,665,000</b>	<b>\$36,162,180</b>	<b>\$22,830,026</b>
<b>Remaining</b>		<b>\$31,728,000</b>		
<b>CONSTRUCTION MATERIALS TESTING</b>		<b>\$17,296,000</b>	<b>\$13,070,553</b>	<b>\$8,538,533</b>
<b>Completed</b>		<b>\$203,000</b>	<b>\$225,133</b>	<b>\$225,132</b>
<b>Active</b>		<b>\$7,791,000</b>	<b>\$12,845,420</b>	<b>\$8,313,400</b>
<b>Remaining</b>		<b>\$9,302,000</b>		
<b>ROCI</b>		<b>\$2,575,000</b>	<b>\$22,322,780</b>	<b>\$19,648,561</b>
<b>LAND COST</b>		<b>\$107,384,000</b>	<b>\$69,223,699</b>	<b>\$69,223,699</b>
<b>PROGRAM LEVEL CONTINGENCY</b>		<b>\$83,178,000</b>		
<b>MISCELLANEOUS</b>		<b>\$2,000,000</b>	<b>\$8,812,812</b>	<b>\$8,812,812</b>
<b>GRAND TOTAL</b>		<b>\$2,341,919,000</b>	<b>\$1,120,062,961</b>	<b>\$978,584,256</b>
<b>REMAINING BOND FUNDS</b>				<b>\$271,415,744</b>

Note: Total Bonds issued to date \$1,250,000,000

# ACCOMPLISHMENTS

through 03.31.19

## IPL PROGRAM GENERAL OPERATIONAL STATUS

The IPL system is currently delivering raw water to TRWD customers from the Richland-Chambers Reservoir. The facilities and pipelines in operation are: the S5X15 Interconnect; pipeline Sections 15-1 and 15-2; the JB3 Suction Reservoir; the JB3 Booster Pump Station; pipeline Section 14; the Midlothian Balancing Reservoirs; pipeline Sections 12 and 13; and the S2X12 Interconnect.

**PL12, 13, MBR** (Pipeline Sections 12 and 13 combined with the Midlothian Balancing Reservoir)

- Project is Substantially Complete and in operation.

**JB3** (250mgd Pump Station expandable to 350mgd)

- Currently in operation, delivering water from Richland-Chambers via the S5X15 interconnect to S2X12 interconnect.
- Completing interior work at the JB3 Data Center and sitework activities.

**PL14** (Pipeline Section 14 that delivers water from JB3 Pump Station to MBR)

- Project is Substantially Complete. Final Completion is expected later this spring pending revegetation of the ROW.

**PL17TUN** (Trinity River Tunnel on Pipeline Section 17)

- Deepening the access shaft to resume tunneling at new profile elevation.
- Receiving steel forms for casting concrete ring segments for tunnel.
- Completing assembly and testing of Tunnel Bore Machine (TBM) for delivery to the site.

**JCC1IN** (Intake Structure and Wet Well for JCC1 Pump Station at Cedar Creek)

- Project is Substantially Complete.
- Final Completion is pending underwater verification survey of the inlet channel.

**JCC1HV** (High Voltage Substation for the JCC1 Pump Station at Cedar Creek)

- Project is Substantially Complete and Oncor has begun mobilizing to bring service to the site.
- Contractor is performing monthly maintenance checks until substation is energized.

**JCC1** (Cedar Creek Lake Pump Station)

- Completed beams and slabs for Pump Station and for Storage Building.
- Installed electrical ductbanks in Electrical Room for Pump Station and Chemical Building.
- Completed the chemical containment walls, tank slabs and stairs, and forming beams at Electrical Room.
- Installing the shoring system and excavating for the 108" gate valve vault.

**PL10, 11** (Pipeline Sections 10 and 11 from the JB4 Pump Station to the KBR Pressure Reduction Facility)

- Commissioned 84" BFV at future JB4 site.
- Completing cathodic protection system installation and protective coatings of pipeline appurtenances.
- Continue final ROW restoration and seeding.

**PL17-18** (Pipeline Sections 17 and 18 from east end of PL15-1 to JCC1 Pump Station)

- Completed joint welding of all 108" pipe for Sections 17 and 18 and preparing for hydrostatic pressure testing.
- Completing cathodic protection system installation, fence and gate installation, and preparing to seed the ROW.

**KBRPRS / S1X10** (Pressure Reduction Station at Kennedale Balancing Reservoir connecting Pipeline Section 10)

- Completed and pressure tested all piping systems.
- Completing installation of valve vaults for 108", 84" and 48" Butterfly Valves.
- Continue electrical, instrumentation and control equipment and wiring.

**OFE03** (Owner-Furnished 108" Gate Valves)

- All valves have been installed for IPL Stage 1 facilities.

**OFE07** (Owner-Furnished pumps, motors and variable frequency drives for JB3)

- All equipment is currently in operation at JB3 Booster Pump Station.

**OFE08** (Owner-Furnished 66", 84" and 108" Butterfly Valves)

- All valves have been delivered and installed.

**OFE09** (Owner-Furnished pumps, motors and variable frequency drives for JCC1)

- OPT reps were in Japan to witness pump performance testing.

**OFE11** (Owner-Furnished 108" Gate Valve)

- No additional testing performed.

# PROJECT SCHEDULE

PROJECT COMPONENTS	2018				2019				2020			
	Q1	Q2	Q3	Q4	Q1	Q2	Q3	Q4	Q1	Q2	Q3	Q4
SECTIONS 12, 13, MBR CONSTRUCTION	SUBSTANTIALLY COMPLETE AND IN OPERATION											
JB3 CONSTRUCTION	[Progress bar]											
SECTION 14 CONSTRUCTION	SUBSTANTIALLY COMPLETE											
SECTION 17 TUNNEL CONSTRUCTION	[Progress bar]											
JCC1 PUMP STATION INTAKE WET WELL CONSTRUCTION	SUBSTANTIALLY COMPLETE											
SECTION 10, 11 CONSTRUCTION	[Progress bar]											
SECTION 17, 18 CONSTRUCTION	[Progress bar]											
KBRPRS/S1X10 (PRESSURE REDUCTION STA.) CONSTRUCTION	[Progress bar]											
JCC1 HIGH VOLTAGE SUBSTATION CONSTRUCTION	SUBSTANTIALLY COMPLETE											
JCC1 CONSTRUCTION	[Progress bar]											



OFE09 Preparing for performance testing of JCC1 Pump 2 in Japan



JB3 View from north end of Electrical Room at JB3 Pump Station



PL17TUN Excavation to deepen tunnel launch shaft

# ACTIVITY STATUS

through 03.31.19

## TITLE COMMITMENTS

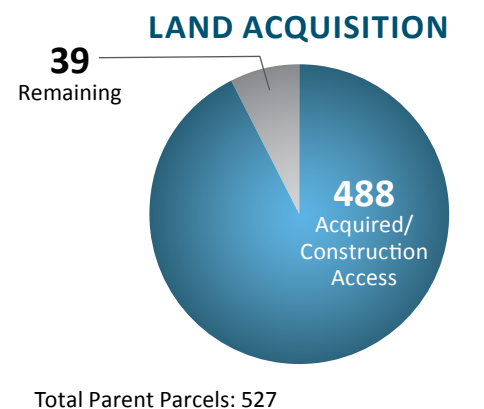
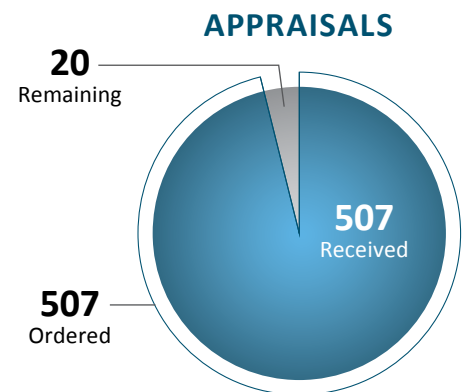
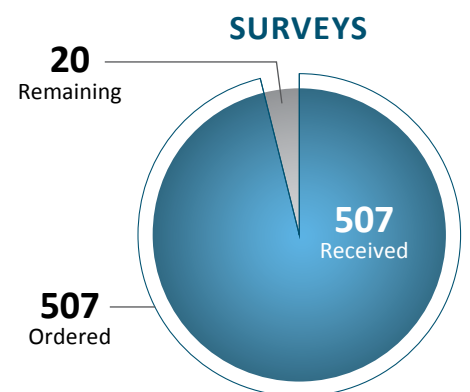
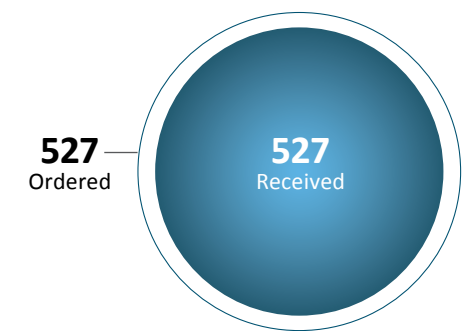

Total Parent Parcels: 527

# M/WBE PARTICIPATION

as of 03.31.19

CONTRACT DESIGN AND CONSTRUCTION	M/WBE & HUB SUB-CONTRACTORS	CONTRACT COMMITMENT		M/WBE   HUB INVOICED TO DATE		TOTAL PROJECT COMPLETED TO DATE	
		\$	%	\$	% (PER COMMITMENT)	\$	%
<b>PROGRAM WIDE PROFESSIONAL SERVICES</b>		\$20,122,412	23%	\$20,027,873	100%	\$85,029,912	96%
Program Management		\$6,636,687	19%	\$6,636,687	100%	\$35,124,711	100%
Conceptual Design / Environmental / Permitting		\$2,644,586	20%	\$2,827,564	107%	\$13,248,699	100%
Value Engineering		\$23,178	5%	\$23,178	100%	\$472,248	100%
Surveying and Mapping		\$3,939,403	33%	\$3,863,616	98%	\$10,593,852	89%
Geotechnical		\$3,638,078	29%	\$3,545,033	97%	\$12,195,421	99%
Corrosion Engineering Services		\$1,053,764	20%	\$761,434	72%	\$4,286,893	80%
Land, Easement Acquisition, & Support		\$1,294,837	37%	\$1,835,058	142%	\$3,429,501	99%
Studies		\$41,717	1%	\$41,717	100%	\$3,587,584	92%
SCADA System		\$384,444	25%	\$43,932	11%	\$622,393	41%
Microwave System		\$465,719	31%	\$449,653	97%	\$1,468,609	96%
<b>DESIGN</b>		\$35,085,309	26%	\$32,553,494	93%	\$121,276,618	91%
Completed		\$26,558,396	27%	\$26,660,569	100%	\$97,160,762	100%
Active		\$8,526,913	24%	\$5,892,926	69%	\$24,115,856	67%
CH2M Hill (Ops Manual)	NDM	\$1,063,611	16%	\$652,424	61%	\$4,049,980	63%
CH2M Hill (JCC1)	JQ, Gupta, APM, HVJ, XENCO	\$1,005,323	30%	\$1,165,809	116%	\$3,123,474	92%
MWH	Garzabury, Kevin Sloan	\$226,705	28%	\$136,372	60%	\$555,735	68%
Black & Veatch	BDS, CAS, JQ, TME	\$2,425,530	25%	\$2,583,711	107%	\$9,700,648	100%
Parsons	Criado, EPB, HVJ	\$144,845	25%	\$112,357	78%	\$681,545	118%
Brown & Gay	AZB, TME, Lamb-Star, NDM	\$1,750,930	25%	\$481,253	27%	\$1,957,619	28%
HDR	AZB, Daltech, Word Wizards, Gupta	\$1,747,469	25%	\$639,501	37%	\$3,180,212	45%
Burns & McDonnell Trans. Mgmt.	Lamb-Star Engineering	\$162,500	18%	\$121,498	75%	\$866,643	96%
Remaining		\$0	0%	\$0	0	\$0	0%
<b>CONSTRUCTION ADMINISTRATION</b>		\$4,533,900	24%	\$2,938,950	65%	\$13,078,975	71%
<b>CONSTRUCTION / OWNER FURNISHED EQUIPMENT</b>		\$86,209,980	12%	\$122,071,203	142%	\$612,140,900	86%
Completed		\$4,252,128	22%	\$4,091,050	96%	\$20,418,083	99%
Active		\$81,957,852	19%	\$117,980,153	144%	\$591,722,817	85%
Pipeline Section 15-1		\$9,317,301	29%	\$6,649,736	71%	\$93,687,256	100%
Garney Construction	Danridge, SYB, Ricochet, Glenko, Carrasco, Cowboy, Gorrondona, Custom Fence, LKT, Astro Johnny, Pam, Father & Son, Bowden's Erosion	\$9,317,301	29%	\$6,649,736	71%	\$93,687,256	100%
JB3		\$15,246,504	26%	\$12,591,573	83%	\$70,276,899	93%
MWH Constructors	Statewide, Cowboy, TX Enviro, Champion, Ram Tool, Rent-a-Fence, Soto Steel, A-Star, Ike, Greystone, LKT, Accurate, Green Scaping	\$13,796,584	27%	\$11,141,653	81%	\$55,859,676	96%
Oncor Electric		\$1,449,920	3%	\$1,449,920	100%	\$4,864,888	8%
Isolux Corsan	Dyna Grid	\$0	0%	\$0	0%	\$923,119	96%
RE Monks		\$0	0%	\$0	0%	\$633,263	13%
Pentair Flow Technologies		\$0	0%	\$0	0%	\$7,995,953	71%
Pipeline Section 12/13/MBR/JB4 Bypass		\$22,074,476	24%	\$22,270,125	101%	\$153,468,983	100%
Thalle Midlothian	LKT, Statewide, Granados, Desert Steel, ETTL, Glenko, A.N.A., Edwards, Buzz, Bradley-Douglas, Pinnacle	\$21,260,756	27%	\$16,449,587	77%	\$143,167,207	100%
BAR Constructors	Fraire's, DFW Aggregates, Ricochet, MMG, LKT, Brock, Garland Heating & Air, Texas Metal, Buzz, Rangel	\$813,719	8%	\$5,820,538	715%	\$10,177,546	100%

# M/WBE PARTICIPATION

as of 03.31.19

CONTRACT DESIGN AND CONSTRUCTION	M/WBE & HUB SUB-CONTRACTORS	CONTRACT COMMITMENT		M/WBE   HUB INVOICED TO DATE		TOTAL PROJECT COMPLETED TO DATE	
		\$	%	\$	% (PER COMMITMENT)	\$	%
Hilco Electric		\$0	0%	\$0	0%	\$0	0%
Hilco Electric		\$0	0%	\$0	0%	\$33,312	100%
Oncor Electric		\$0	0%	\$0	0%	\$90,918	100%
Pipeline Section 15-2		\$3,947,329	16%	\$20,981,334	532%	\$50,743,593	100%
BAR Constructors	Ricochet, Fraire's, DFW Aggregates, Brock, Tidy Toilets, KDAT, Juan Cantu, Buyer's, RAM, Rangel, LKT, Greenscaping, Environmental Safety	\$3,947,329	16%	\$20,981,334	532%	\$50,743,593	100%
Pipeline Section 14		\$5,925,447	22%	\$6,957,922	117%	\$47,130,639	100%
Garney Construction	AEA, Gorrondona, JC Welding, LKT, Statewide, Bowdens	\$5,925,447	29%	\$6,957,922	117%	\$47,080,639	100%
Magellan	Captioned Crossing Inspection Section 14	\$0	0%	\$0	0%	\$50,000	100%
Pipeline Section 17		\$15,151,701	23%	\$3,912,376	26%	\$66,003,319	70%
IPL Partners	LKT, Industry Junction, Eagle Aggregate, Suncoast Res, ATS Drilling, RECS, ANA, Alliance, Ram, JC Welding, Luis Moreno	\$9,736,346	23%	\$1,679,025	17%	\$24,619,196	51%
Thalle Midlothian	Fleet Lube, Rambo Controls, AE Trucking, MKI Construction, Stome Water Management, Industry Junction, Ortega Land Clearing	\$5,415,356	24%	\$2,233,350	41%	\$41,384,123	90%
JCC1		\$3,088,051	3%	\$28,216,960	914%	\$42,121,493	40%
BAR Constructors	Industry Junction, K&A Steel, Ricochet Fuel, Ricochet Fuel, Tidy Toilets, Buzz Custom Fence	\$961,990	6%	\$17,952,090	1866%	\$18,903,323	100%
BAR Constructors	Industry Junction, K&A Steel, Ricochet Fuel, Ricochet Fuel, Tidy Toilets	\$0	0%	\$9,377,718	0%	\$9,377,718	15%
Ebara		\$0	0%	\$0	0%	\$3,832,089	66%
Lambda Construction	High Voltage	\$2,126,061	37%	\$887,152	42%	\$5,252,112	90%
Oncor Electric		\$0	0%	\$0	0%	\$4,756,250	100%
Pipeline Section 10/11		\$7,207,043	20%	\$16,400,128	228%	\$55,127,306	96%
IPL Partners	LKT, Industry Junction, Eagle Aggregate, Suncoast Res, ATS Drilling, RECS, ANA, Alliance, Ram, JC Welding, Luis Moreno	\$5,761,202	24%	\$2,845,974	49%	\$41,555,700	95%
Oncor Electric		\$0	0%	\$0	0%	\$17,452	100%
BAR Constructors	Industry Junction, VSG Trucking, Ricochet, MMG Disposal, Garland HVAC, CMC Rebar, Buzz Custom Fence, K&A Steel, Rangle Land Surveying	\$1,445,841	11%	\$13,554,154	937%	\$13,554,154	98%
Valve Packages		\$0	0%	\$0	0%	\$13,163,328	92%
<b>CONSTRUCTION MANAGEMENT</b>		\$19,155,809	37%	\$16,122,916	84%	\$40,834,246	79%
Completed		\$5,928,803	38%	\$6,337,128	107%	\$18,004,219	115%
Active		\$13,227,006	37%	\$9,785,788	74%	\$22,830,026	63%
<b>CONSTRUCTION MATERIALS TESTING</b>		\$7,283,832	56%	\$4,835,481	66%	\$8,538,533	65%
Completed		\$219,036	97%	\$219,036	100%	\$225,132	100%
Active		\$7,064,796	55%	\$4,616,445	65%	\$8,313,400	65%
ROCIP		\$900,661	4%	\$347,888	39%	\$19,648,561	88%
<b>TOTAL</b>		\$173,291,903	22%	\$198,897,804	115%	\$900,547,745	86%
<b>LAND COST</b>		\$0	0%	\$61,892	0%	\$69,223,699	310%
<b>MISCELLANEOUS</b>		\$0	0%	\$0	0%	\$8,812,812	13%
<b>GRAND TOTAL</b>		\$173,291,903	22%*	\$198,959,696	115%	\$978,584,256	87%
		M/WBE/HUB Invoiced				\$198,959,696	
		Grand Total Invoiced				\$978,584,256	
		* Exclusions Invoiced				\$269,422,254	
		MWBE %				28.06%	

\* Denotes participation percentage excluding cost of pipe and owner furnished equipment.

# PROJECT COMPONENTS

PIPELINE SEGMENTS	CORE PROJECT	DESCRIPTION
Section 9		KBR Turn-Out Tee to existing Benbrook Connection Pipeline (10.6 mi. 84" dia. Pipe + 5 mi. 120" Tunnel)
Section 10	◆	KBR Turn-Out Tee to KBR (2.4 mi. 84" dia. Pipe)
Section 11	◆	JB4 to KBR Turn-Out Tee (10 mi. 84" dia. Pipe)
Section 12	◆	JB4 to existing CC and RC Pipelines (2.2 mi. 108" dia. Pipe)
Section 13	◆	MBR2 (Midlothian Balancing Reservoir) to JB4 (11 mi. 108" dia. Pipe)
Section 14	◆	JB3 to MBR2 (Midlothian Balancing Reservoir) (14.9 mi. 108" dia. Pipe)
Section 15	◆	JB2 to JB3 (28.5 mi 108" dia. Pipe)
Section 16		JRC1 (Joint Richland Chambers Lake Pump Station) to JB2 (12.3 mi. 96" dia. Pipe)
Section 17	◆	Cedar Creek Connection to JB2 (11.2 mi. 108" dia. Pipe)
Section 18	◆	JCC1 (Joint Cedar Creek Lake Pump Station) to Cedar Creek Connection (0.2 mi. 108" dia. Pipe)
Section 19		LP1 (Lake Palestine Pump Station) to Cedar Creek Connection (42.3 mi. 84" dia. Pipe)

PUMP STATIONS	CORE PROJECT	DESCRIPTION
Palestine Pump Station		150 mgd with new intake
Cedar Creek Pump Station	◆	277 mgd with new intake
Richland Chambers Pump Station		250 mgd Ultimate Design Capacity
Booster Pump Stations		Two @ 347 mgd and one @ 197 mgd (◆ one 347 mgd station - JB3)

SUPPORT FACILITIES	CORE PROJECT	DESCRIPTION
Reservoirs	◆	Three reservoirs (80 – 400 mgd) - two for booster pump stations and one for balancing. Two of the reservoirs are core projects – JB3R and MBR
Deep Tunnels		5 mi of 10' dia. tunnel @ Crowley (included in length of Section 9)
Substations & High Voltage Transmission Lines		Six substations and 4 mi. of high voltage transmission lines (◆ two substations)
Microwave Communications and SCADA System	◆	Provides remote operations capability and system monitoring

